

BROILER



FEEDING



WATERING



FEED STORAGE & TRANSPORT



LIGHTING



www.tavsan.com.tr

PAN FEEDING

TAVSAN pan feeding system meets the high standard of poultry growing from the first day to the end of the flock and leads to better Feed Conversion Rates. Ease of access to the feed, ease of cleaning, minimum feed waste are some of the features that the TAVSAN pan feeding system offers. You have several alternatives of pan feeders where, one of them will definitely be the one that you are looking for;



The feed hopper, 90kg or 170kg feed capacity, assures an excellent feed flow into the feeding line

The pan feeding system can also be supplied with "Double Outlet Hoppers" for mid-line installations.

The mechanical switch in the end-pan stops the motor automatically when all the pans are filled with feed.

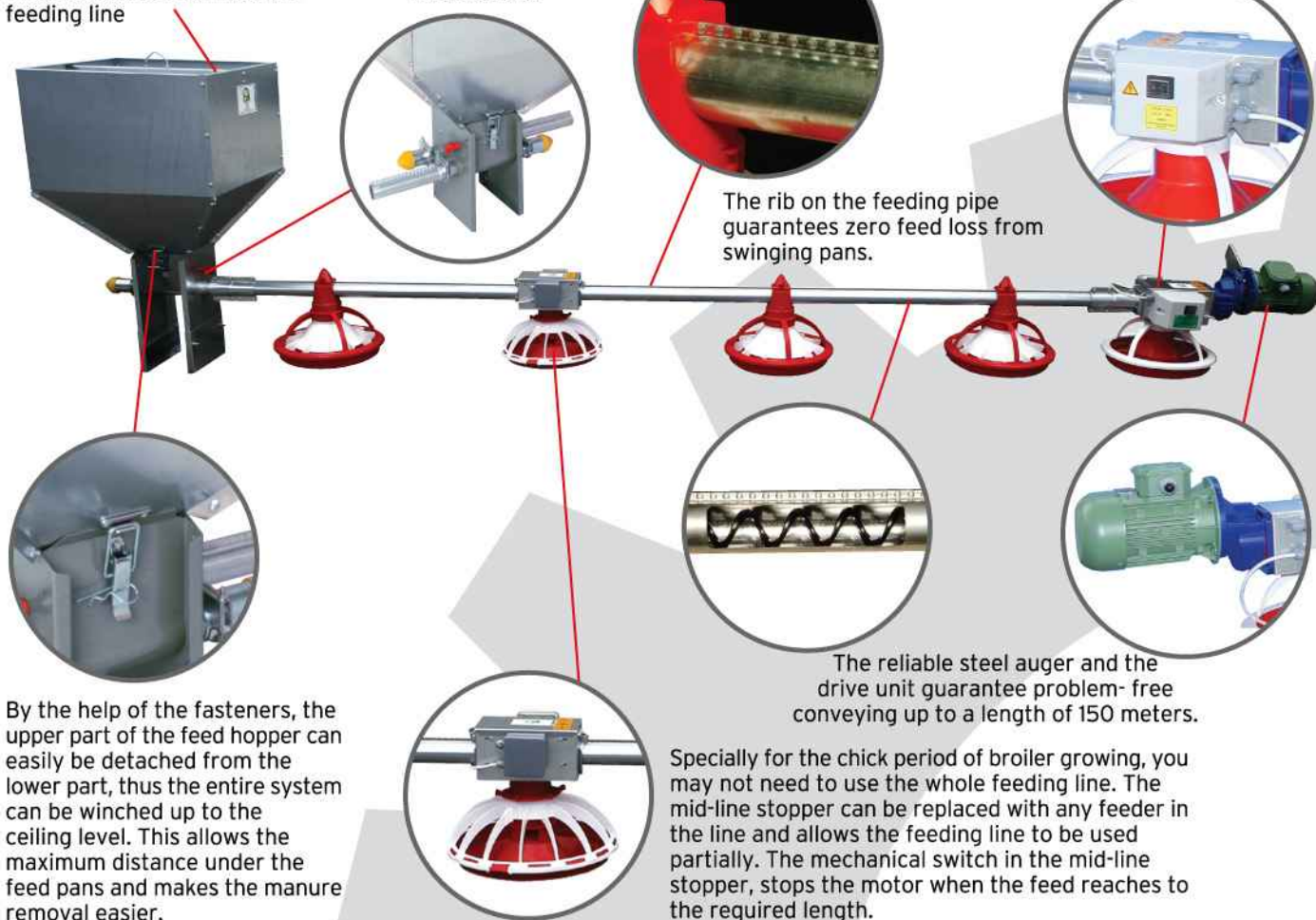

KALKAN



KEMER

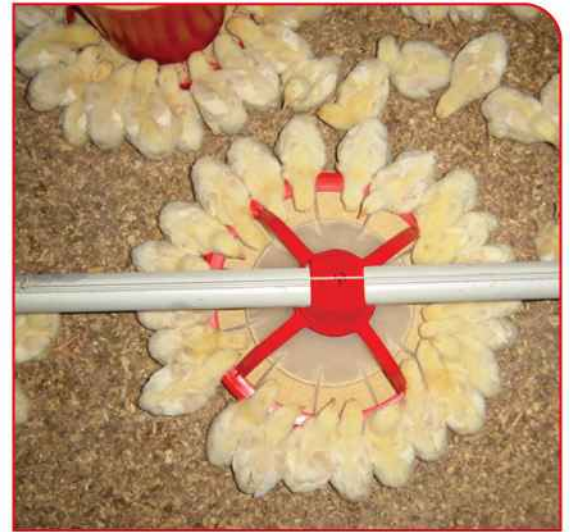

The middle part design does not let the chicks sleep in the feeder thus leads to a cleaner feed. The V-shaped pan bottom distributes the feed equally all around the pan.



EFES



BODRUM



The height of the pan and the distance between the grills allows the chicks to get in and out the feeder easily.

- ✓ Ease of assembling with the sliding top support
- ✓ The height of the pan allows the chicks to get in and out the feeder easily.
- ✓ 5-stage feed adjustment assures the required amount of feed to be filled into the feeders.
- ✓ The feeders is composed of 4 parts and makes the system to be assembled and disassembled easily.



PAN FEEDING

BELEK / KAS

- ✓ Tray of the feed pan can be cleaned without getting it out from the grill with the hinge system it has. It enables to clean the feeding line quicker and with less labor.
- ✓ Feed flow can be provided equally from the 'chick feeding window' on the feed pan's cone when the system is on the ground.
- ✓ Feed level in all line can be easily adjusted with the new feed level adjustment screw
- ✓ Tray of the feed pan designed in a conical shape distributes the feed equally around the feed pan
- ✓ Feed flow can be inhibited in the unnecessary times with the slide integrated to its middle part.



This new KAS feed pan with 10 grills and wider feeding spaces provides all the advantages Belek feeder for ducks and heavy broilers

999



The successful feeder used in thousands of broiler houses. The 72mm and 52mm pan height alternatives makes it more effective during the chick period

DIDIM



TECHNICAL SPECIFICATIONS

Maximum length of the system	150m	
Feed pipe can be supplied with 2, 3 or 4 holes	External diameter: 45mm Internal diameter: 42.6mm	
Standard drive unit:	50Hz, 3 phase, 350rpm Special voltages and powers are available on request	
Conveying capacity:	approx. 450kg / hour	
Suspension:	recommended to be at every 3 meters	
Hopper Alternatives	90 KG	170 KG
Single outlet	✓	✓
Double outlet	✓	✓

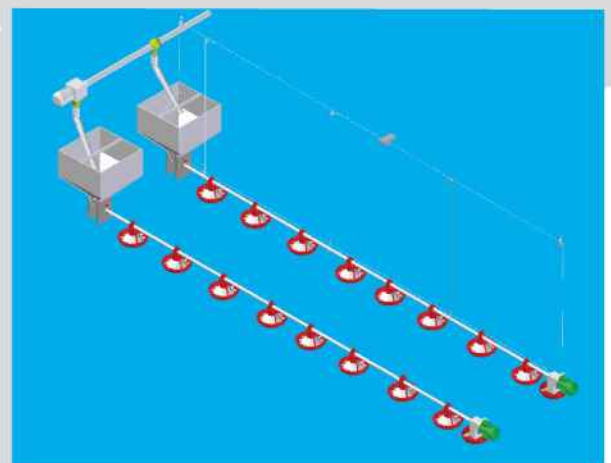

LIFTING WITH MOTORED WINCH

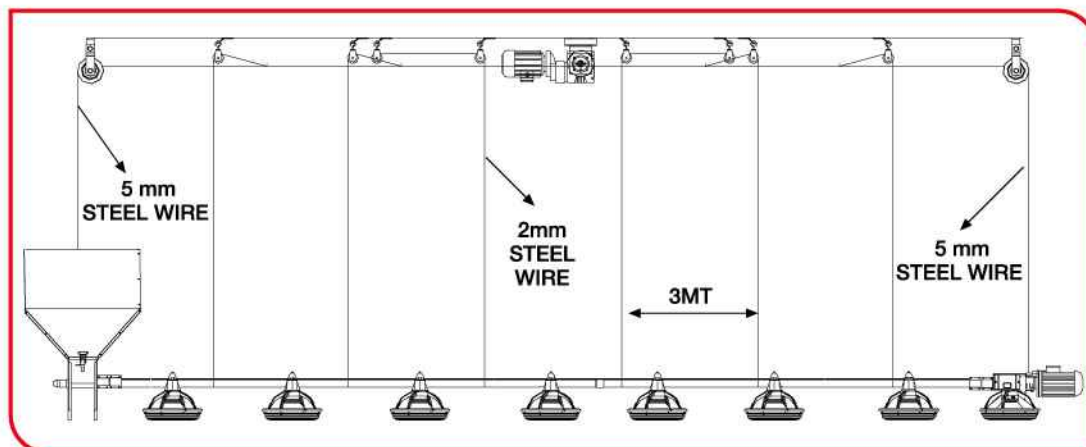

LIFTING WITH MANUAL WINCH

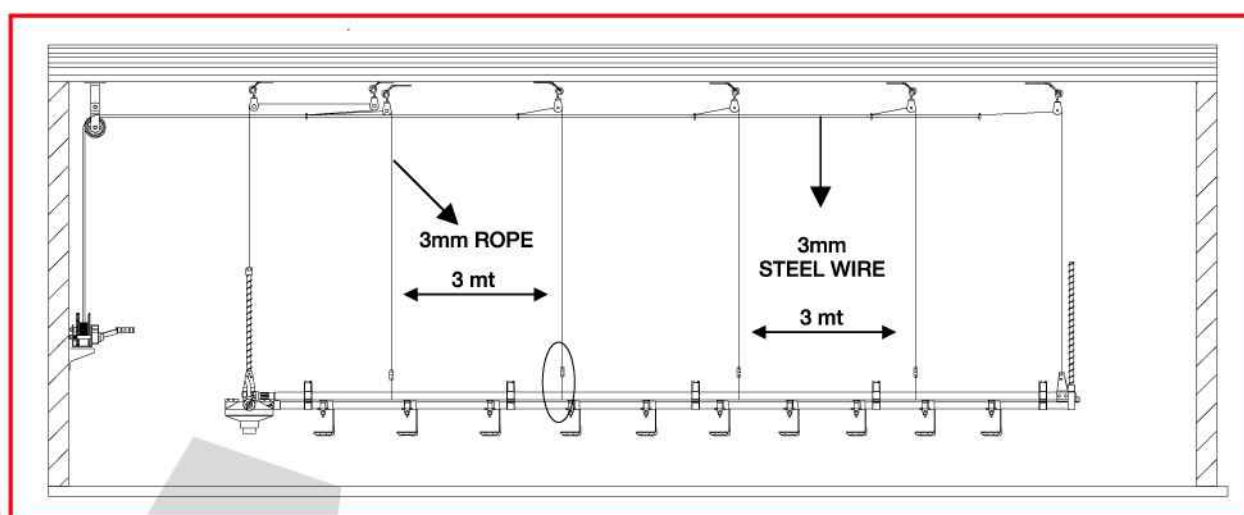

PULLEYS



80mm
STEEL
PULLEY



40mm
PLASTIC
PULLEY



22mm
PLASTIC
PULLEY

WALL & CEILING WINCHES



Wall winch 540 Kg
For nipple watering
up to 60m



Wall winch 900 Kg
For pan feeding
up to 50m



Ceiling winch 900 Kg
For nipple watering
over 60m



Ceiling winch 900Kg
For pan feeding
up to 60m



Ceiling winch 1350Kg
For pan feeding
over 60m

NIPPLE WATERING



TOP NIPPLE

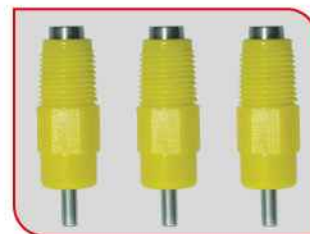

TOP COMBI NIPPLE

The heart of the system is the high-quality stainless steel 'top-nipple' which has a flow rate of 30-40cm³/min with sideways and 70-80cm³/min with upwards (at 3mm vertical lift) action. All flow rates are valid for 20cm water column. The nipple pipes can either be supplied by an aluminium profile or with a galvanized pipe. Alternatively the system can be supplied with "top-combi nipple" also, having the same flow rates. The only difference is that the outer housing of the stainless steel nipple pins is covered with a high-quality plastic. Top Nipple and Top-Combi Nipple are also available with single-arm drip cup.

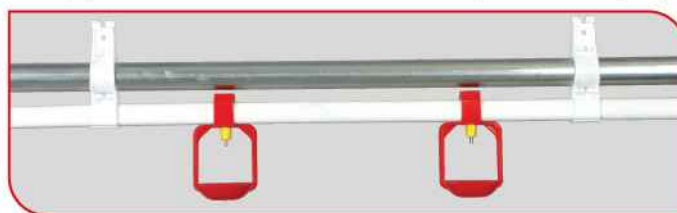

The nipples used in TAVSAN nipple watering system are made of top quality stainless steel. All plastic components are also made of quality materials. Their design guarantees a long service life. The arrangement of the valve with a large cross section provides optimum water supply.

TAVSAN nipple watering systems offer you the following advantages:

- ✓ a simple, reliable water supply
- ✓ constantly fresh and clean drinking water
- ✓ nearly no maintenance or cleaning
- ✓ improved results
- ✓ trouble-free rearing
- ✓ dry manure

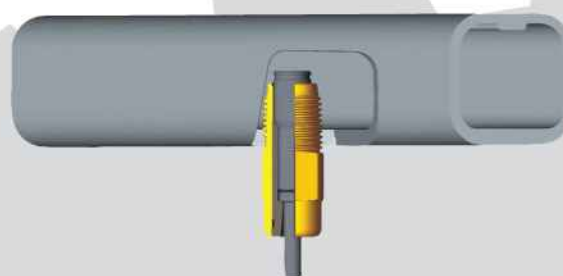

MEDICATOR GROUP

ADVANTAGES

- ✓ The dosage remains precise, regular and constantly proportional.
- ✓ The Medicator is completely hydraulic and so requires no electrical connections.
- ✓ Precise dosing avoids waste.
- ✓ The liquid dispenser is easily installed in the water line.



The non-electric proportional medicator injects exactly the right dose of concentrate into the drinking water, ensuring success every time.

NIPPLE WATERING

PRESSURE REGULATOR

Water is supplied over a pressure regulator with integrated flush facility. Both versions are available for the end connection or the middle connection.

SLOPE REGULATOR

The slope regulator can be used in uneven houses. Has 3 versions of delivery; For 10cm, 15cm and 20cm slopes.

BREATHING UNIT WITH VALVE

Breather-revolving unit is installed at the end of the drinking line.

FLUSH BREATHING UNIT

The flush breather unit at the end of each drinking line works full automatically and does not need to be operated by hand at flushing process anymore.

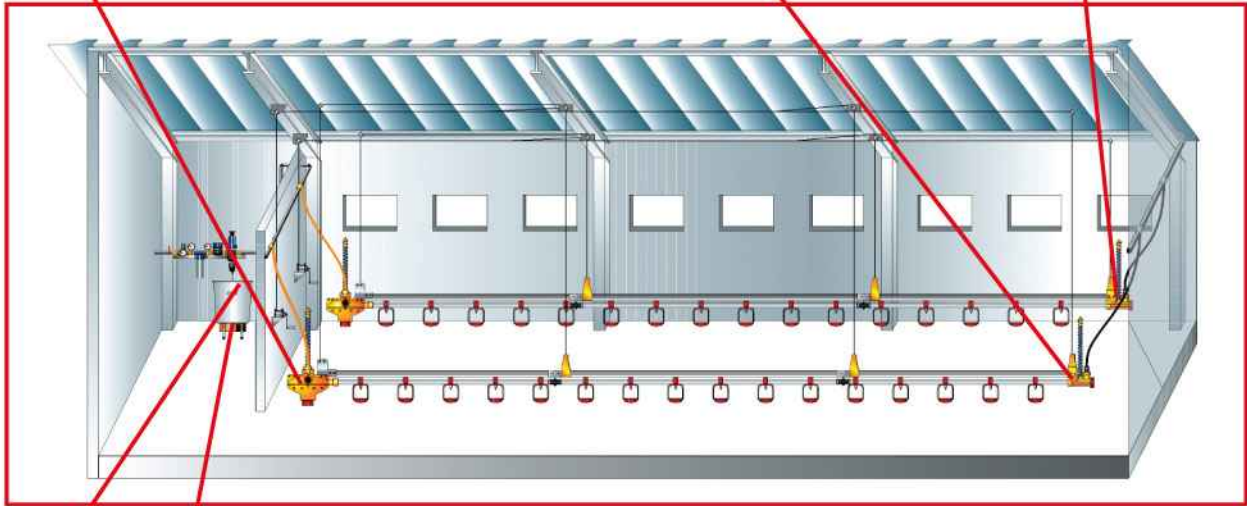

MIXER

In the mixer the additions e.g. vitamins are stirred permanently while drinking water is added.



STARTER CUP

A starter-cup can be supplied for the beginning phase of the rearing period.



TAVSAN DUDEN J-LOCK NIPPLE

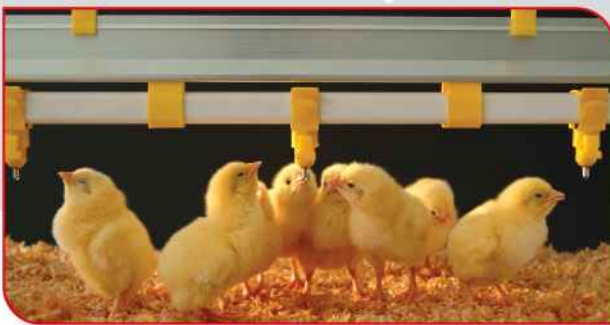

Tavsan's latest innovation "Duden J-Lock Nipple" is designed to get the maximum water flow while keeping the litter dry. The nipple can be activated vertically and horizontally thus can be used throughout the rearing and growing period for broilers, breeders and layers. The high-quality stainless steel and the plastic housing ensure a long service life.



System with square pipe

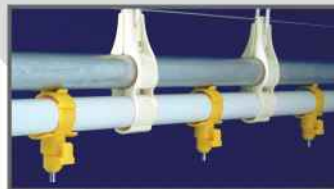

System with round pipe



Nipple alternatives



Optional dripcups

FEED STORAGE & TRANSPORT



1 The high-quality galvanization (350 gr/m²) and the corrugation lead to an excellent light reflection and prevent any greenhouse effect inside the silo.



2 Mechanical filling kit is a standard in all of our silos. Pneumatic filling is an option. Should you require, both of the filling alternatives are available in a single silo.



3 The standard feed view window on the silo body allows you to check the feed level inside the silo.



4 The standard ladder, safety cage and handrail are designed for maximum safety.



5 Extended ladder to the ground level is also available, as an option.

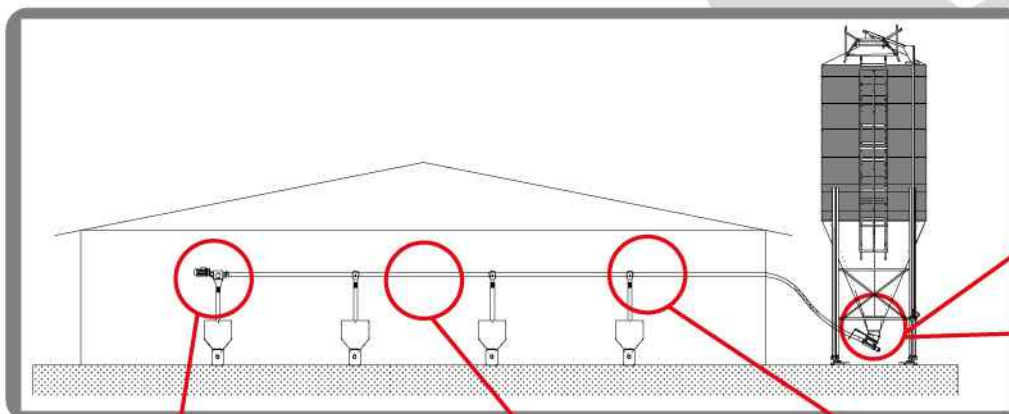

90 mm or 75 mm
DRIVE UNIT

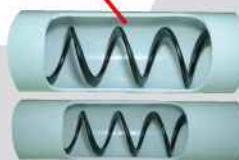

90 mm or 75 mm
PVC PIPE

Feed in
take boot
alternatives

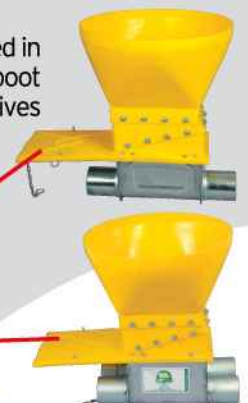

90 mm or 75 mm
DROP
OUTLETS

FEED STORAGE & TRANSPORT



1 The high-quality galvanization (350 gr/m²) and the corrugation lead to an excellent light reflection and prevent any greenhouse effect inside the silo.



2 Mechanical filling kit is a standard in all of our silos. Pneumatic filling is an option. Should you require, both of the filling alternatives are available in a single silo.



3 The standard feed view window on the silo body allows you to check the feed level inside the silo.



4 The standard ladder, safety cage and handrail are designed for maximum safety.



5 Extended ladder to the ground level is also available, as an option.

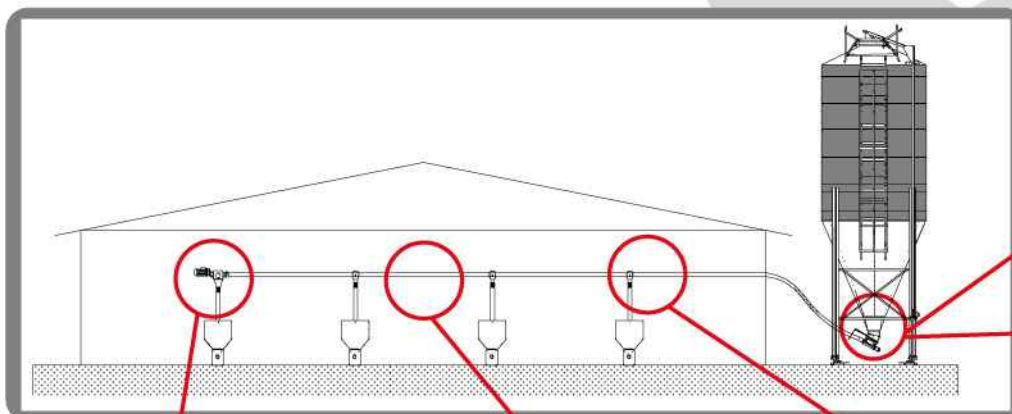

90 mm or 75 mm DRIVE UNIT

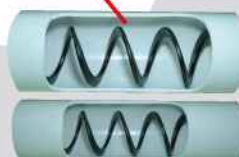

90 mm or 75 mm PVC PIPE



Feed in take boot alternatives



90 mm or 75 mm DROP OUTLETS

AUTOMATIC DRINKERS

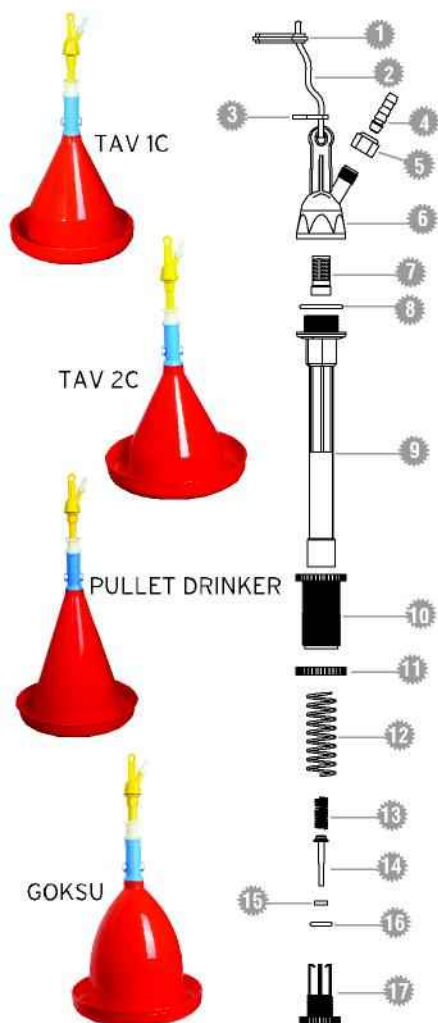

- 1 CORD ADJUSTER
- 2 HANGER CORD
- 3 HOSE HOLDER
- 4 HOSE INLET
- 5 NUT FOR HOSE INLET
- 6 MECHANISM CAP
- 7 FILTER
- 8 O-RING FOR MECHANISM CAP
- 9 MECHANISM PIPE
- 10 WATER LEVEL ADJUSTER
- 11 NUT FOR LEVEL ADJUSTER
- 12 MECHANISM SPRING
- 13 SPRING FOR VALVE
- 14 PIN FOR VALVE
- 15 WASHER FOR VALVE PIN
- 16 WASHER FOR VALVE
- 17 VALVE BODY

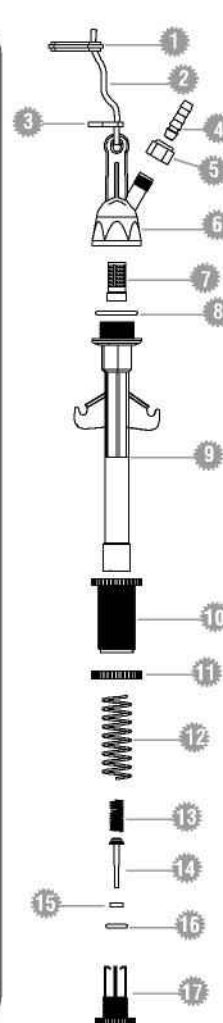

DICLE BELL DRINKER

The ideal bell drinker that can be used for broilers, layers and breeder rearing. The weight ball mechanism allows the drinkers to work automatically on the floor as well as suspended.

MANUAL FEEDERS & DRINKERS

TECHNICAL SPECIFICATIONS

SUSPENDED FEEDER-10KG

SUSPENDED FEEDER-20KG

BUCKET FEEDER-4KG

BUCKET FEEDER-8KG

TRAY FEEDER

	SUSPENDED FEEDER-10KG	SUSPENDED FEEDER-20KG	BUCKET FEEDER-4KG	BUCKET FEEDER-8KG	TRAY FEEDER
DIAMETER(mm)	352	411	278	304	353
RIM HEIGHT(mm)	67	72	38	38	33
RIM WIDTH(mm)	33	49	40	40	
TOTAL WEIGHT(gr)	1296	1734	742	1058	344

TRAY FEEDER

The corrugated pan surface attracts the chicks to feed and also prevents them to sleep on the pan.

2.5 lt. CHICK DRINKER

5 lt. CHICK DRINKER

BUCKET FEEDER 8KG

BUCKET FEEDER 4KG

These two manual feeders are suitable to be used in chick period of broilers and also for the first phase of pullet rearing.



In thousands of broiler houses, it is proven that the blue & green light has a great effect on broiler performance. The blue and green lights are set at 3m intervals alternatively down the house, in a standard layout. The festoon fitting and the electrical cable come unassembled so individual layouts can be designed. Although when only the blue lights are operating the house appears dark to the human eye the birds perceive it 13 times brighter. When the green lights come on three hours prior to lights out bird activity increases. The dark period allows the birds to rest and develop.



- ✓ Very low mortality levels
- ✓ Improved body weight
- ✓ Better Feed Conversion Rates
- ✓ Increased uniformity of the birds
- ✓ Lower electricity consumption
- ✓ Longer service life
- ✓ Nearly no maintenance



Dimmer



Adaptor



Electrical cable & festoon fitting



Lamp cover



www.bimur.com • 0212 949 20 27

TAVSAN POULTRY EQUIPMENT is the oldest and the biggest poultry equipment manufacturer in Turkey. Since the establishment date, 1975, TAVSAN manufactures feeding, drinking, lighting, heating, ventilation, feed storage and transport, cage and environmental control systems. Besides manufacturing a complete range of equipment for livestock farming, TAVSAN also performs sales, marketing and after sales service to its customers.



TAVSAN INTERNATIONAL TRADE CO.

Dudullu OSB Nato Yolu Cad. No: 267

34775 Umraniye Istanbul - Türkiye

Tel: +90 216 364 11 05 (pbx) • **Faks:** +90 216 364 66 30

www.tavsan.com.tr • tavsan@tavsan.com.tr

